

INTRODUCTION

AIM: To design an entrance gate for Chandigarh International Airport.

OBJECTIVE: - To design a gate that represents the spirit of the people of Punjab.

- Monumental scale structure.

- Should have an aesthetic appeal from both frontal and aerial view.

- Blend of modern and traditional architecture.

ROLE OF LOCATION: - Chandigarh being the first ever planned city of India marks a huge role in the field of architecture.

- As the administrative capital, Chandigarh holds a reknown recognition in representing the culture of Punjab.

DESIGN CONCEPT- What defines Punjab?

CHENAB

JHELUM

RAVI

BEAS

PUNJAB- THE LAND
OF FIVE RIVERS

SUTLEJ

- The character of Punjab lies in its prosperity which is rooted to its chief occupation of agriculture.
- The meet of five rivers in Punjab marks an important geographical statement that influences the culture of the place.
- This feature engenders the bucolic traditions of Punjab and hence marks the theme of our concept.

The site is located at the road leading towards international Airport from Sas Nagar (Mohali): An IT Hub of the region close to the vicinity of the beautiful city "Chandigarh".



WHY A RIVER BASED CONCEPT?

Free flow of rivers denotes a metaphorical representation of free spirited essence.

It denotes the core reason of existence of Punjab's culture.

An initiative to balance the aquatic eco system.

Gives an eco friendly approach to the concept.

AQUATIC WILDLIFE CONSERVATION AWARENESS

- The Indus River Dolphin lives in the Indus river in Pakistan and India.
- This unique mammal is on the urge of extinction, with less than 1000 dolphins left.
- Causes for extinction:
 - Human- made irrigation systems
 - Water pollution
 - Poaching
 - Fishing
- The concept of representing rivers also indicates the aquatic life conservation awareness.



THE INDUS RIVER DOLPHIN

IMPLEMENTATION OF CONCEPT

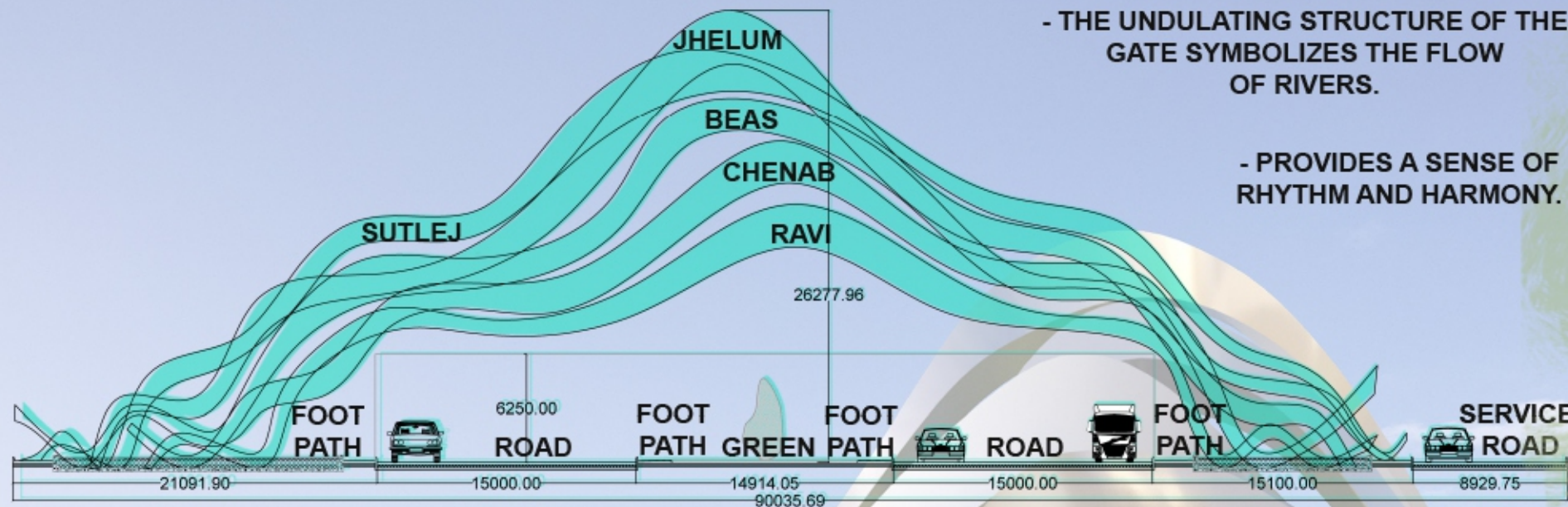

THE ORDER OF RIVERS AS WE MOVE TOWARDS THE AIRPORT IS AS SHOWN IN THE ADJACENT SKETCH, RAVI BEING THE SHORTEST, AT THE FRONT & SUTLEJ, BEING THE LONGEST OF ALL, AT THE LAST.

- FUTURE REDUCTION IN CENTRAL MERIDIAN AND FOOT PATH
- FLEXIBLE DESIGN TO ENCORPORATE ROAD WIDENING ASPECT

THE PROVISION OF PEBBLES ENHANCES THE ESSENCE OF THE AQUATIC WORLD AND MERGES WITH THE THEME. THE PURPOSE OF THESE PEBBLES IS TO DISPLAY THE NAMES OF THE RIVERS TO ELABORATE THE CONCEPT TO THE AUDIENCE.

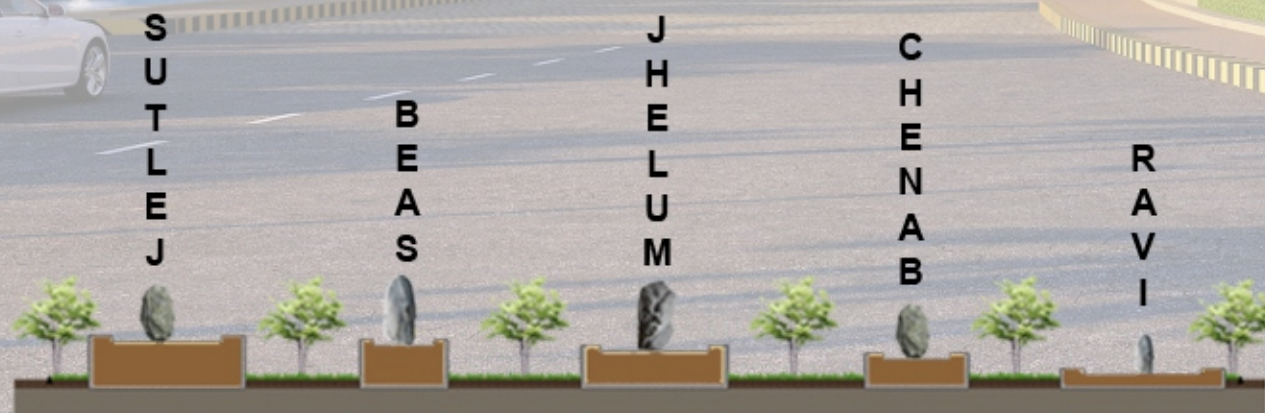

TYPICAL SECTION OF THE ROAD

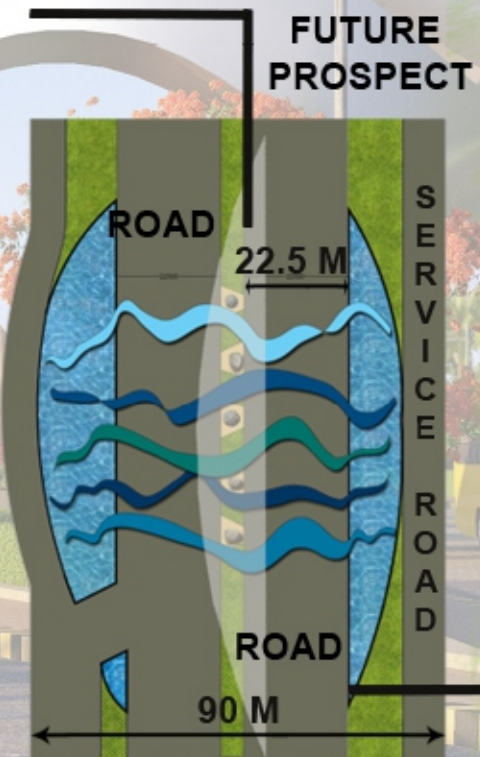

THE PROVISION OF CRESCENT WATER BODIES ON THE SIDES DEPICTS THE RISE AND FALL OF WATER.

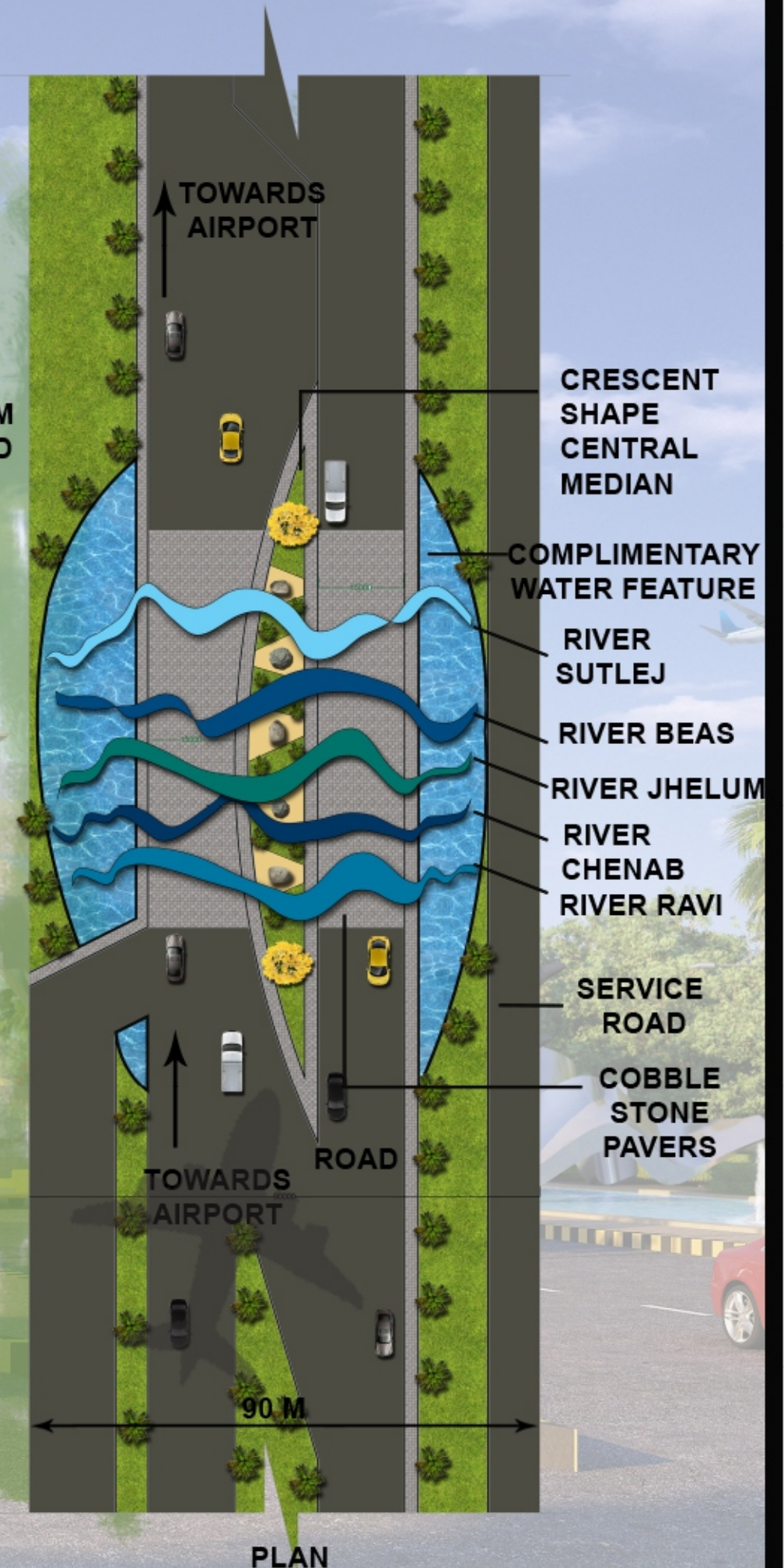

DESIGN VIEWS



VIEW FROM THE AIRPORT ROAD

DESIGN FEATURES

- THE DESIGN IS AN AMALGAMATION OF CULTURAL AND MODERN ASPECTS OF ARCHITECTURE.
- THE MODERN AESTHETICS REPRESENTS THE CULTURAL ROOTS OF PUNJAB.
- THE STRUCTURE CREATES A DRAMATIC EXPERIENCE AND DEPICTS A STORY TO THE VIEWER.

AERIAL VIEW

MATERIAL SPECIFICATIONS

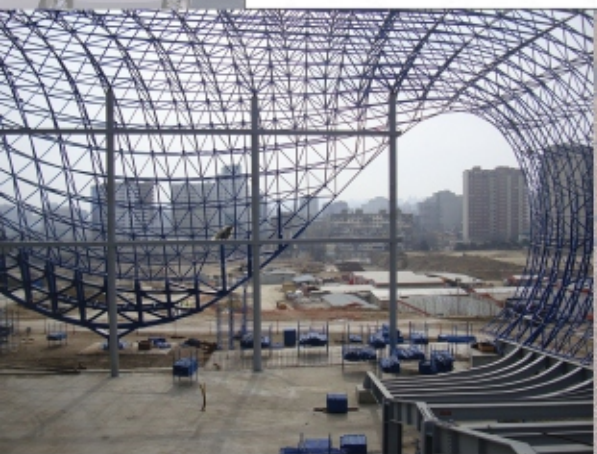
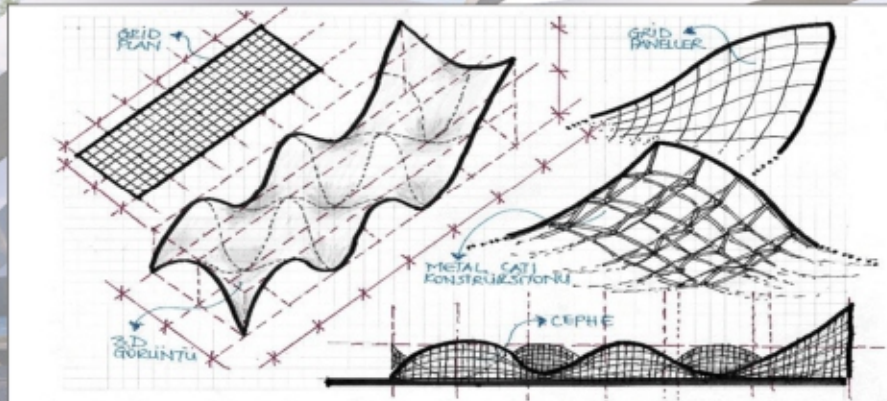

- DYNAMIC SPACE
FRAME STRUCTURE.

- WITH STAINLESS
STEEL CLADDING
IN CHROME FINISH.



ENTRANCE GATE DESIGN AT CHANDIGARH INTERNATIONAL AIRPORT

DESIGN VIEWS



INSIDE THE COMPLEX

DESIGN FEATURES

- PATHWAY PROVISION AT THE PERIPHERY OF THE CRESCENT SHAPED CENTRAL MEDIAN FOR VISITORS TO STOP AND HAVE A GLANCE AND ALSO FOR THE MAINTAINANCE FACULTY.
- THE PRESCENCE OF REFLECTION POND CREATES A MICRO CLIMATE WHICH PROVIDES A SOOTHING EXPERIENCE.

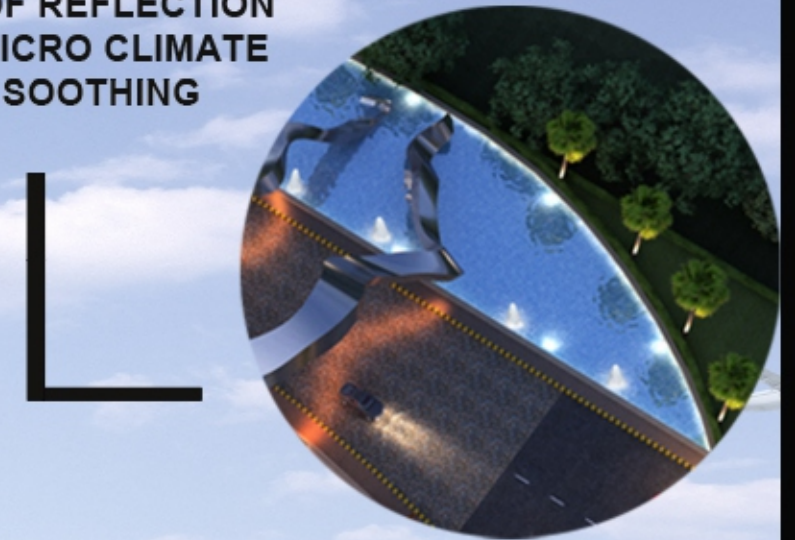

FRONT VIEW

-- THE PAVERS INSIDE THE COMPLEX COMPRISE OF COBBLER STONES THAT REFLECTS THE IDEA OF MERGING WATER WITH PEBBLE STONES.

- SCULPTURES OF DOLPHINS ARE DESIGNED AROUND INDUS RIVER FRAME TO CREATE AWARENESS OF ENDANGERED AQUATIC LIFE OF INDUS RIVER SPECIES.



STRUCTURAL SYSTEM

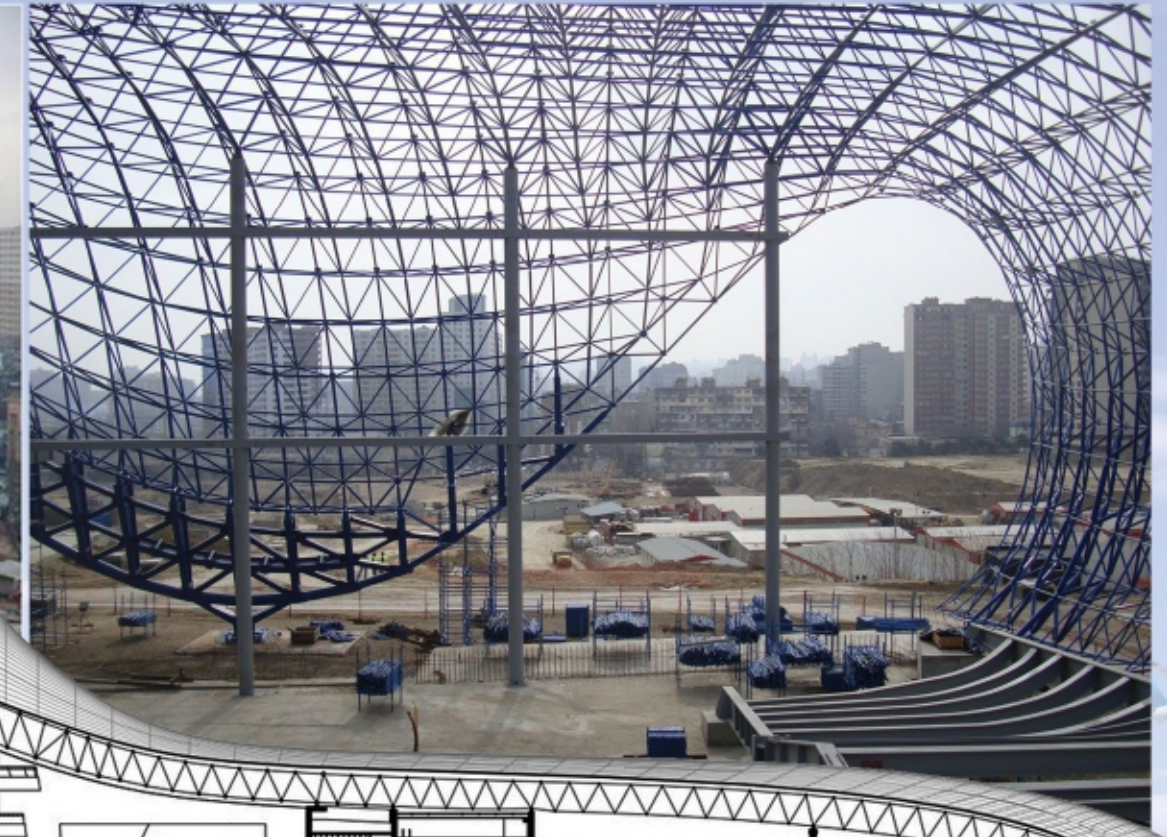
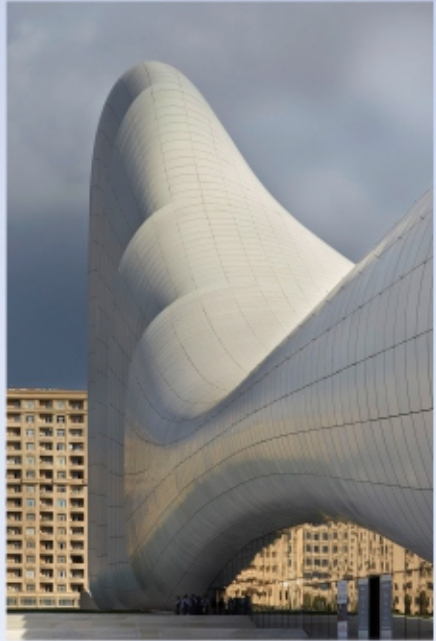

CLADDING OVER THE FRAME

DYNAMIC SPACEFRAME WITH
STRUCTURE STEEL CLADDING

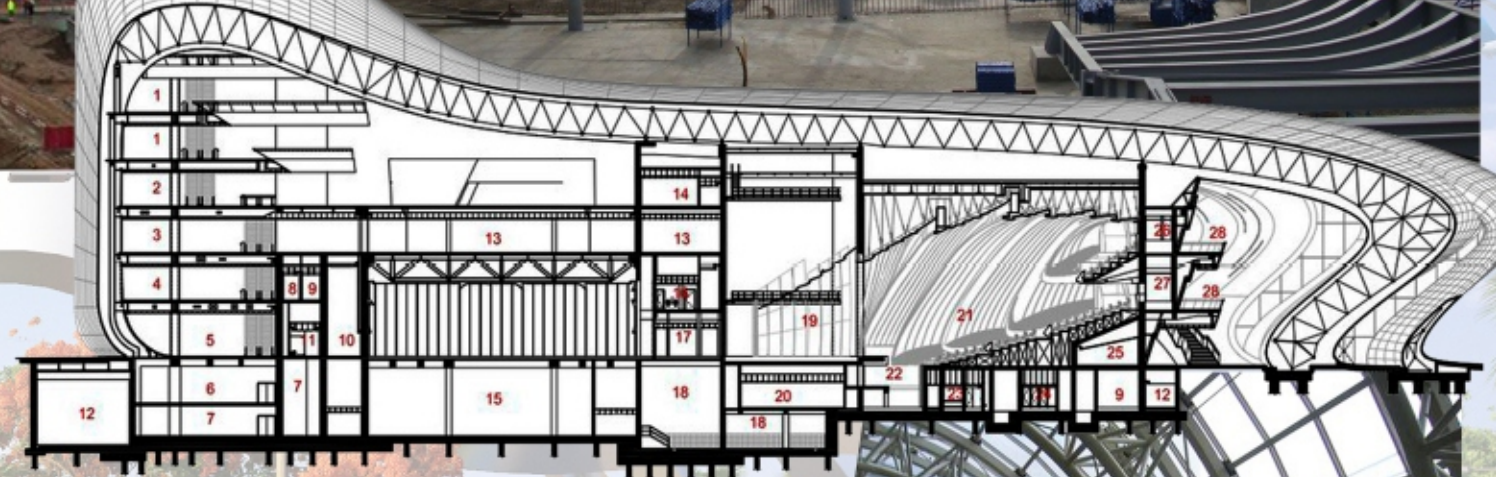

- WITH STAINLESS
STEEL CLADDING
IN CHROME FINISH.

- FORM FOLLOWS FUNCTION

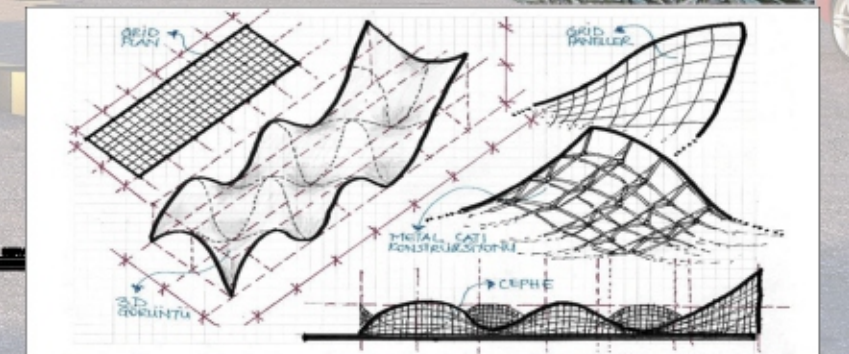
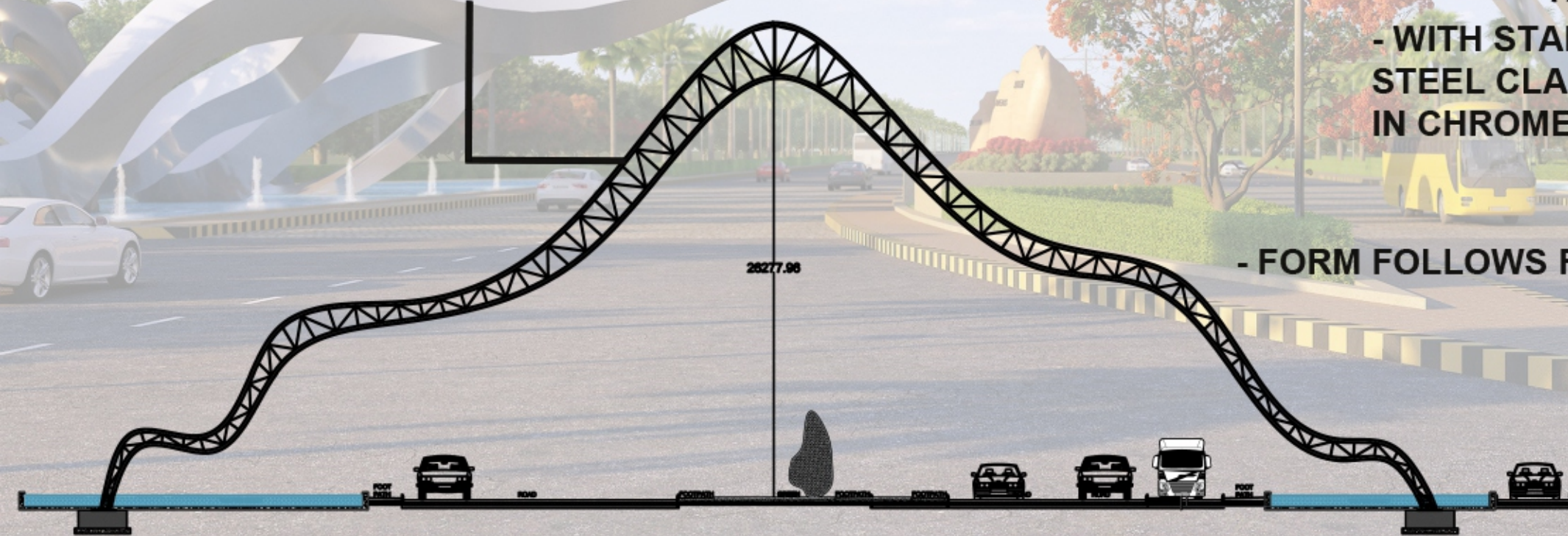

ENTRANCE GATE DESIGN AT CHANDIGARH INTERNATIONAL AIRPORT

AERIAL VIEW OF THE COMPLEX



ENTRANCE GATE DESIGN AT CHANDIGARH INTERNATIONAL AIRPORT

FRONT VIEW OF THE COMPLEX

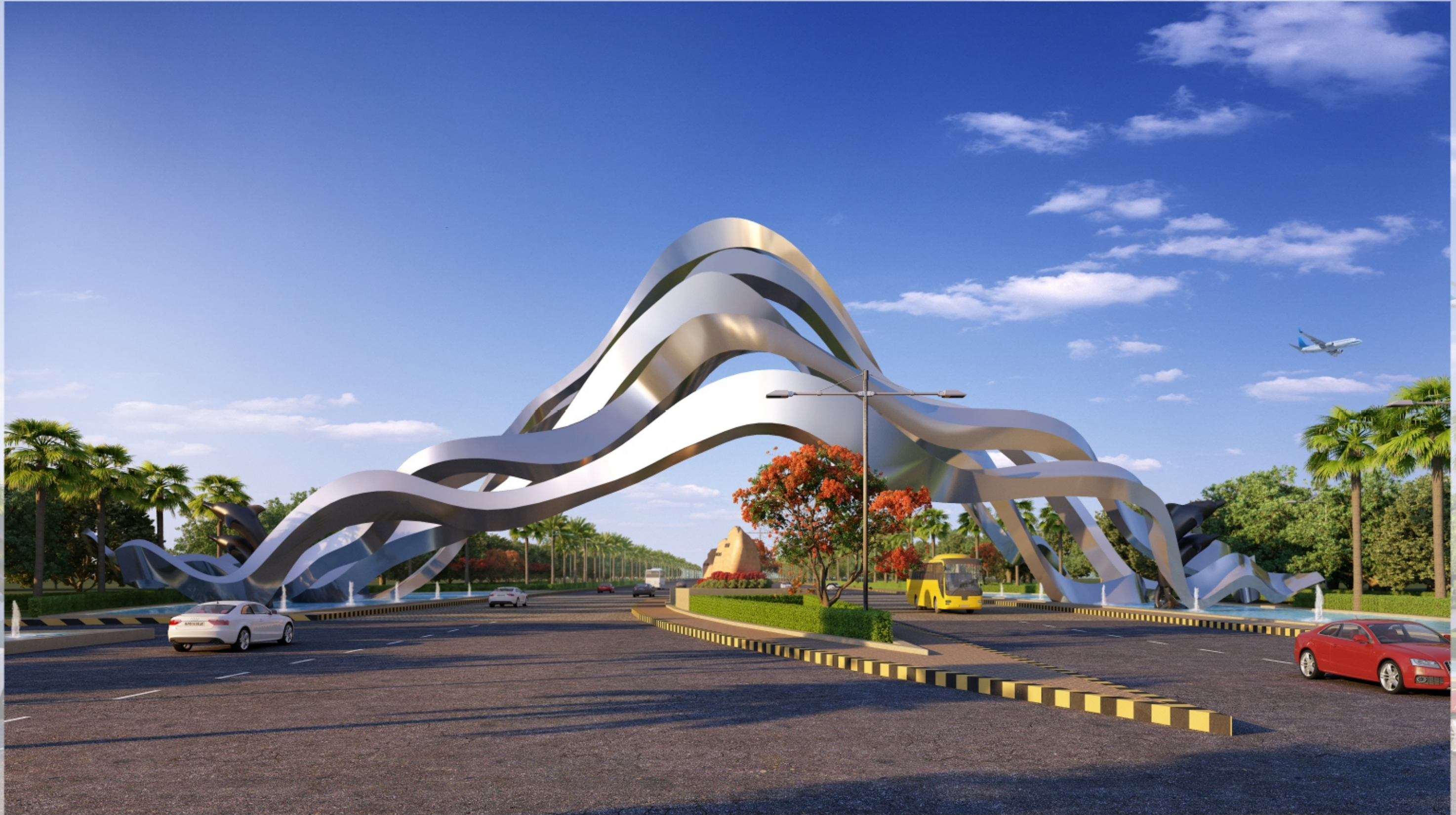

ENTRANCE GATE DESIGN AT CHANDIGARH INTERNATIONAL AIRPORT

REAR VIEW OF THE COMPLEX



ENTRANCE GATE DESIGN AT CHANDIGARH INTERNATIONAL AIRPORT

INSIDE VIEW OF THE COMPLEX



ENTRANCE GATE DESIGN AT CHANDIGARH INTERNATIONAL AIRPORT